

CanTorque Single Chisel

Nut Splitter



PROUDLY CANADIAN
Design • Sale • Service • Rental • Calibration



CanTorque Single Chisel Nut Splitter

Hydraulic Solutions

The CanTorque Hydraulic Single Nut Splitters offer

- ✦ Compact design
- ✦ Easy to use
- ✦ Seven models of nut splitter to choose from
- ✦ Unique angled head design for a variety of applications
- ✦ Single acting hydraulic cylinder with spring-return
- ✦ Operated by hydraulic pump with rated oil pressure of 700 bar(10,000psi).

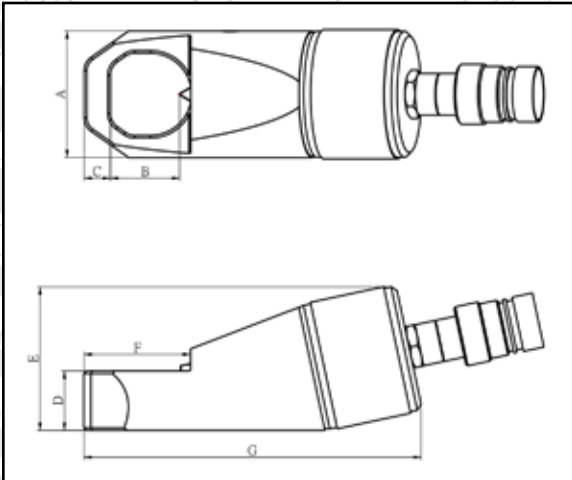

DIMENSIONS (mm)

MODEL	A	B	C	D	E	F	G
CTNS-1319	40	21	7	19	50	29	120
CTNS-1924	54	25	10	25	62	40	146
CTNS-2432	64	33	13	30	76	52	180
CTNS-3241	70	42	16	36	87	65	205
CTNS-4150	90	52	21	45	108	96	245
CTNS-5060	106	60	24	54	125	92	288
CTNS-6075	156	80	27	75	184	110	365

CTNS TECHNICAL DATA

MODEL	CTNS-1319	CTNS-1924	CTNS-2432	CTNS-3241	CTNS-4150	CTNS-5060	CTNS-6075
Bolt Range	M6-M12	M12-M16	M16-M22	M22-M27	M27-M33	M33-M39	M39-M48
Hex Nut Range (mm)	10-19	19-24	24-32	32-41	41-50	50-60	60-75
Capacity (ton)	6.23	11.24	18.39	25.69	38.92	54.88	102.76
Oil Capacity(cm ³)	15	20	60	80	155	240	492
Dimensions(mm)							
Length	170	191	222	244	288	318	393
Width	40	54	64	75	94	106	156
Height	48	62	72	88	105	128	181
Net Weight(kg)	1.2	2.0	3.0	4.4	8.2	11.8	34.1
Gross Weight(kg)	2.6	3.6	5.2	7.0	13.6	18.4	42.7

*Suitable for ≤ grade 8 nuts ONLY. Nut hardness must not exceed HRC-44. Splitting stainless, square and star nuts are not permitted.

CT® Authorized Distributor



info@cantorque.com

14635 119 Avenue
Edmonton, AB T5L 2N9
Twitter: @cantorque
www.cantorque.com

Main: +1 780 436 2000
Fax: +1 780 732 0905
Toll Free: +1 877 436 4364